

# STANDARDSPECIFICATIONS

The Hoopa Modular Building Enterprise specifications are carefully designed to provide value comfort and appeal. Our designs allow you to choose the home that is best suited for your family's needs and lifestyle. All Hoopa Modular homes are designed with careful attention to detail and unmatched quality.

We also allow complete personalization to the Hoopa Modular home of your choice. Please see personalization guidelines on changes that can be made to all standard Hoopa plans.

## FLOORS:

- 11 7/8" Open Joist 2000 floor truss, 16" o.c. for 28' wide homes with double LVL perimeter band.
- Optional or Per Plan: 9 3/8" Open Joist 2000 floor truss, 16" or 19'2" o.c. for 24' wide homes with double LVL perimeter band.
- Optional: Double 2 x 8 perimeter band with 2 x 8 floor joist, 16" o.c. for 24' & 25' wide homes
- Optional: Double 2 x 10 perimeter band with 2 x 10 floor joist, 16" o.c. for 28' wide homes
- Metal joist hanger on marriage wall girder
- 3/4" T&G O.S.B. glued and nailed or OPTIONAL: 3/4" T&G Plywood glued and nailed;

## WALLS:

- Exterior wall construction 2 x 6, 16" o.c. all models
- Double top plate on exterior walls
- Interior wall construction 2 x 4, 16" o.c.
- 1/2" Finished drywall with primer paint and orange peel finish
- Protective sheathing on marriage walls
- 7/16" O.S.B. sheathing on exterior walls - partial or full per plan
- R-19 Fiberglass insulation (Kraft faced)

## ROOF AND CEILING:

- Permanent 12" roof overhangs with fascia and soffit finished on 24' models
- Folding 12" roof overhangs with fascia and vented soffit on 28' wide models
- Nominal 12" Gable overhangs on all models
- 6/12 Roof pitch, folding engineered roof trusses 16" o.c., standard on all ranch and two story homes
- 12/12 Roof pitch, trusses 16" o.c., standard on all capes
- 5/8" O.S.B. Roof sheathing
- 25 year Architectural self sealing shingles with 15# underlayment
- R-38 fiberglass insulation (Kraft faced)
- 5/8" Drywall ceilings with stippled or orange peel finish
- Shingle over ridge vent
- Ceiling height 8'

- 2 x 6 Perimeter and 2 x 4 ledger strip, with 2 x 6 joist on 1st floor ceilings of two story homes
- Ice and water guard

#### EXTERIOR:

- High performance vinyl sliding or single hung windows with optional removable grids per individual house design.
- Fiberglass 3/0 front door with 1/2 round glass, and 3/0 rear door with 9-lite glass
- Wood brick mould exterior doors frames
- 6/0 x 6/8 Vinyl sliding patio door with Low "E" glass (per plan)
- Hardi-Plank Lap Siding with 50 year warranty
- Battery operated door chimes

#### INTERIOR:

- Vinyl floor covering in kitchen, baths and utility room
- Vented closet shelving
- 6 panel moulded interior doors with 1 ½ pair hinges - primed white
- Prefinished white colonial baseboard molding (3-1/2")
- Prefinished white colonial door casing (2-1/4")
- Windows with cased openings Prefinished white and cultured marble sills
- Mushroom Style interior doorknobs or optional lever handle
- Mortised doorknob plunger
- Wire shelf over Washer/Dryer

#### KITCHEN:

- Vented range hood with light
- Double-bowl, 8" stainless steel sink with single lever faucet and spray
- Self-edged, high pressure laminated countertops with back splash
- Mid-Continent custom quality oak kitchen cabinets, NKCA approved
- 9" cabinet over refrigerator standard
- 15" Soffit or cove molding over kitchen cabinets (per plan)
- Chandelier in dining room
- Recessed spotlight over kitchen sink

#### BATHROOM:

- One piece cultured marble vanity top
- Bath vanities to match kitchen cabinet finish, with single lever faucet
- One-piece fiberglass tub & shower unit with single lever anti-scald faucet
- Bath fan with light
- 1.6 gallon elongated water closet
- Beveled mirror with 4 bulb strip light
- One towel bar and paper holder per bath
- Corner soaking tub (per plan), corner shower unit (per plan)

#### PLUMBING:

- Copper water lines stubbed through floor - Type "L" Hard
- Schedule 40 PVC waste and vent lines
- Shut off valves at all sinks and water lines
- 40-Gallon gas or electric water heater

## ELECTRIC:

- 200 amp electrical service, full size panel box
- AC/DC smoke detectors, per code
- 2 Outside weatherproof G.F.I. receptacle
- Bedroom lights on switched receptacle - overhead lights optional
- Interior G.F.I. protection where required
- Arc fault breakers for all bedrooms
- 2 Exterior lights at front door on all 2-Stories - 1 on ranch style
- 2 TV jacks
- 2 Telephone jacks

## WARRANTY:

- Ten (10) year major structural defect protection
- One (1) year manufacturers product warranty

## CODES:

- UBC and/or International Residential Code
- CABO - 1 and 2 Family Code
- CABO - Model Energy Code
- National Electrical Code

*Hoopa Modular Building Enterprise may, in it's sole discretion, change any specifications as to materials or design which are required by the availability of materials, vendor pricing, or any other good and sufficient reason, provided such changes in specifications do not affect the structural integrity of the home.*

## Roof Schematic

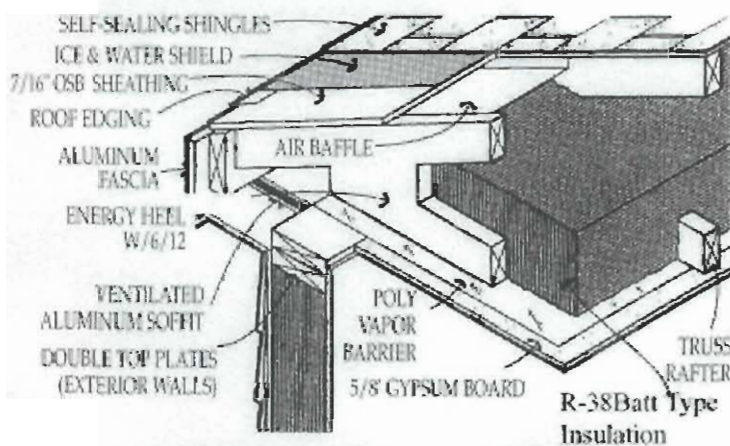

## Wall Schematic

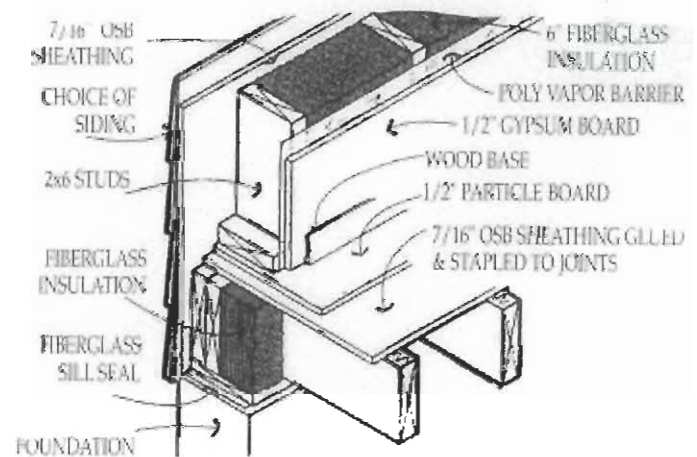

# Standard Features

---

- Floor Joists - Open Joist 2000 11 7/8" or 9 1/4" -- 16" O. C. Per plan
- Optional: 2 x 8", 10" and/or 12" floor joists @ 16" O. C.
- Double 2 x 8", 10" and/or 12" Rim Joists, or
- Double LVL perimeter beam - which ever is applicable - per plan
- 3/4" T&G Oriented Strand Board flooring, or
- Optional: 3/4" T&G A.P.A. plywood flooring
- 2x6 Exterior Wall Framing @ 16" O.C.
- 2x4 Interior Wall Framing @ 16" O.C.
- 1/2" Drywall on walls
- 5/8" Drywall on ceilings
- All Exterior Outlet Boxes are caulked to reduce Air Infiltration
- 200 Amp Electrical Service Panel
- R-19 Sidewall Insulation
- R-38 Ceiling Insulation
- 7/16" OSB Sidewall Sheathing
- Hardi-Plank Lap Siding
- Vinyl Low-E Insulated Windows (single hung or sliders)
- Prefinished aluminum or vinyl fascia and vinyl soffit
- 6/12 Roof Pitch Standard (Cape Code 12/12 others per design)
- Air Baffle Every Truss Bay
- Continuous Ridge Vent
- 1/2" Roof Sheathing
- #15 Felt with 25 year 3-Tab Shingles
- Fiberglass Insulated Exterior Doors - Front & Rear
- 8' Ceiling Height
- Shaw FHA 25oz carpet with rebond pad

## Other Standard Features

---

- Norcraft Kitchen Cabinets & Bath Vanities-- Prefinished Oak
- Laminate Kitchen Countertops with self-edge and backsplash
- Cultured Marble Vanity with Integral Bowl and Moen center set
- Stainless Steel Sink in Kitchen with Moen Single Lever Faucet
- One Piece Fiberglass Tub/Shower with Moen Single Lever Faucet
- Vitrous China Elongated Water Saver Water Closets
- Power Vent in Bath w/Light
- OSB Sheating on marriage walls -full or partial per plan
- Vented Range Hood w/Light
- Door Chime Front with optional rear
- 6 Panel Colonial Moulded Interior Doors - White with matching trim
- Colonial casing and base - White
- Bi-Fold Closet Doors
- Wire Ventilated Closet Shelving
- Telephone and TV Jacks
- High Performance Windows with Low-E Glass

## Options

---

- |  |  |
|--|--|
| <input type="checkbox"/> Upgrade Kitchen Cabinet Styles and Colors | <input type="checkbox"/> Dormers                               |
| <input type="checkbox"/> Hardwood Flooring                         | <input type="checkbox"/> Shutters                              |
| <input type="checkbox"/> Oak Doors and Trim                        | <input type="checkbox"/> Vaulted/Cathedral Ceilings            |
| <input type="checkbox"/> Wood Windows                              | <input type="checkbox"/> Appliances                            |
| <input type="checkbox"/> Bow and Bay Windows                       | <input type="checkbox"/> Gas or Wood Burning Fireplaces        |
| <input type="checkbox"/> Half Round/Crescent Windows               | <input type="checkbox"/> Recessed Entry                        |
| <input type="checkbox"/> Cedar Lap Siding                          | <input type="checkbox"/> 7/12 through 12/12 Roof Pitch         |
| <input type="checkbox"/> Hardi-Board Siding                        | <input type="checkbox"/> Exterior Accent Siding                |
| <input type="checkbox"/> 40 Year Architectural Shingles            | <input type="checkbox"/> Architraves, Door Pediments           |
| <input type="checkbox"/> Tray and/or Coufered Ceilings             | <input type="checkbox"/> Upgraded light fixtures               |
| <input type="checkbox"/> Garden Tubs w/wo Whirlpool Jets           | <input type="checkbox"/> Medicine cabinets and mirror upgrades |
|  | <input type="checkbox"/> Vaulted Ceilings                      |